

PUSH BUTTON (ILLUMINATED)



Series 64

DESCRIPTION

Integral Series 64 Illuminated Push Button Switches are of modular construction giving a freedom to the customer to build his own switch given all the sub- assemblies. A robust construction using stainless steel sheets, the switch is built to take rough usage over a long period of time. The design enables the user to change the multi-chip LED's from the front of the panel without removing the switch from the panel. Consisting of the Push Button, Body and the Switch modules the switch assembly lends itself to a large number of combinations.

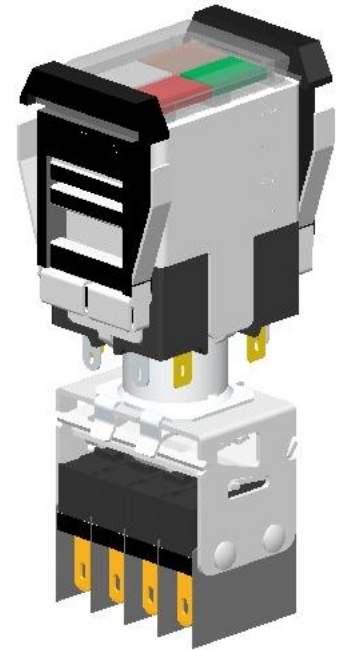

DIMENSIONAL DETAILS :

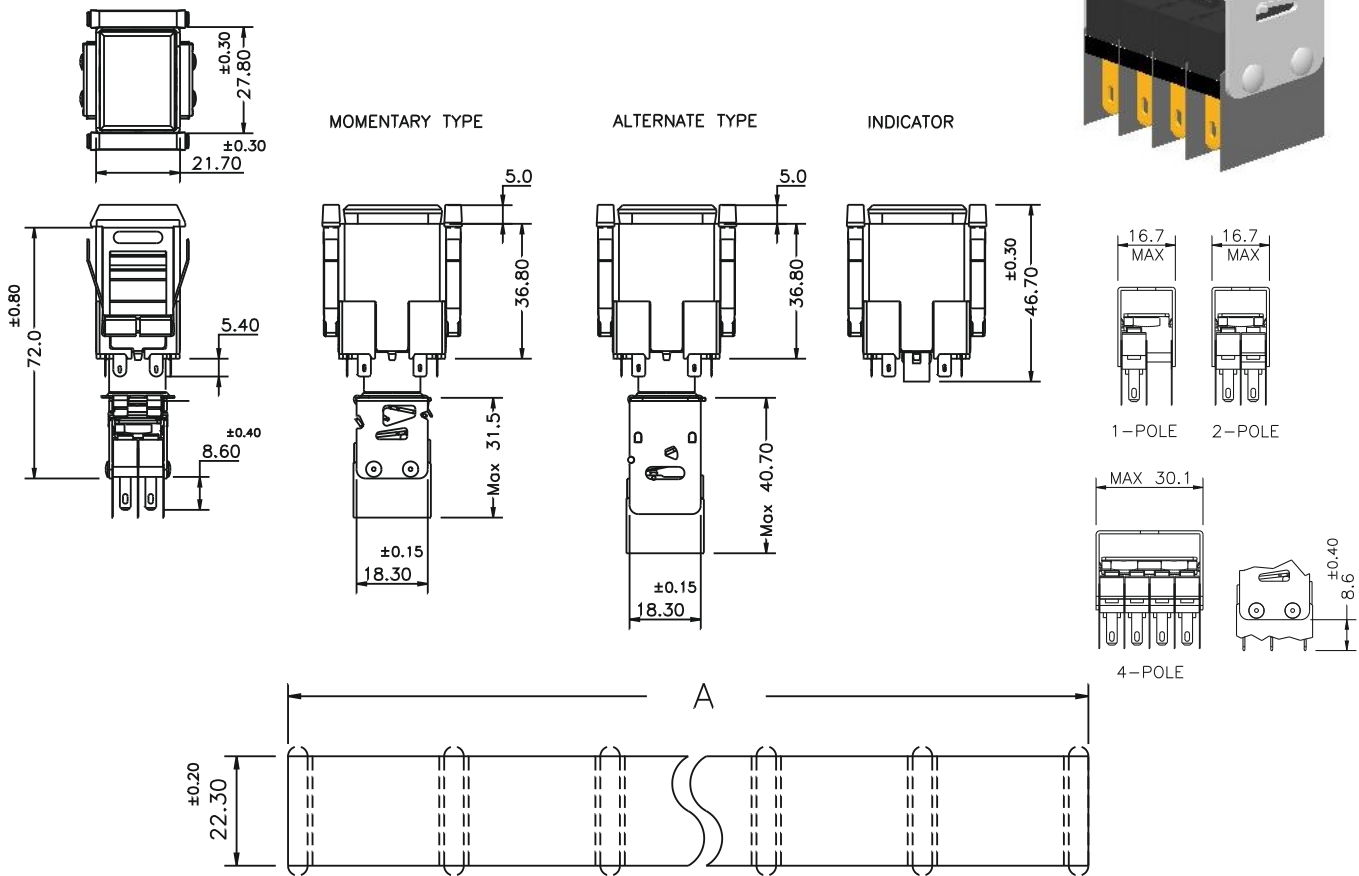

Panel thickness 1.6 to 7.90 mm.

Short barrier

Dimensions	1	2	3	4	5	6	7	8	9	10	11	12
Type Number of units	36.1	68.0	99.9	131.8	163.6	195.5	227.4	259.3	291.1	323.0	354.9	386.7

Dimensional tolerance is ± 0.30 mm
 in the case of gang-mounting of 12 units or more, calculate as follows

$$\text{Short barrier type: } 31.86 n + 4 \begin{matrix} +0.30 \\ -0 \end{matrix}$$

All Dimensions in mm.

EXPLODED VIEW

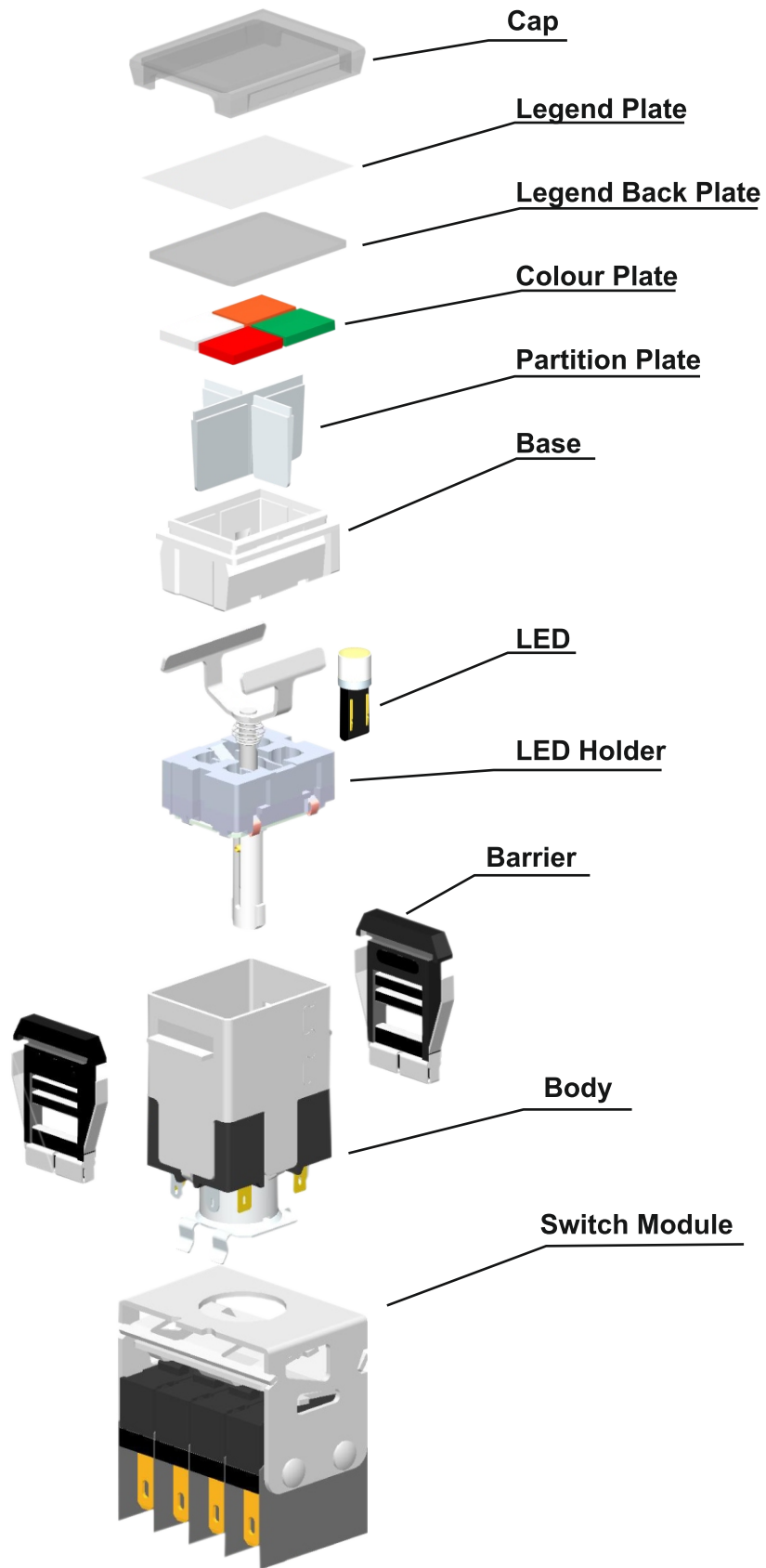

All Dimensions in mm.

SWITCH

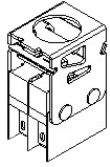

64 SW 2M
(MOMENTERY)

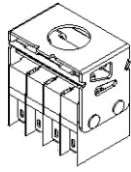

64 SW 4M
(MOMENTERY)

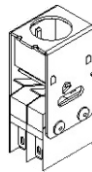

64 SW 2A
(ALTERNATE)

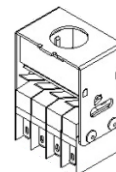

64 SW 4A
(ALTERNATE)

BODY

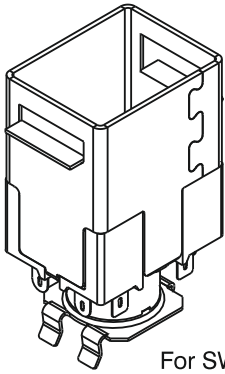

For SWITCH

64 BD

- S-Switch
- L-Indicator

Display layout

- A - Full
- B - Split-2
- C - Split-3/4

Voltage

- 05 V DC
- 12 V DC
- 24 V DC

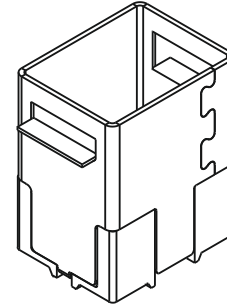

For INDICATOR

BARRIER

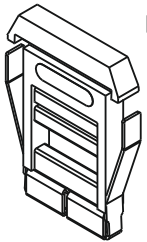

64 BR

Colour

- K - Black
- W - White

LED



64 LD

Colour

- R - Red
- W - Milky White
- D - Orange
- G - Green

COLOUR PLATE

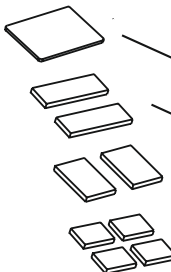

64 CP

layout

- 1
- 2
- 3
- 4

Colour

- R - Red
- W - Milky White
- D - Orange
- G - Green

BUTTON

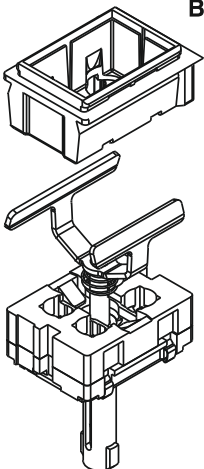

64 BT

- S-Switch
- L-Indicator

Display layout

- A
- B
- C
- D
- E
- F
- G
- H

Voltage

- 05 VDC
- 12 VDC
- 24 VDC

All Dimensions in mm.

SPECIFICATION

Electrical & Mechanical

- | | |
|-----------------------------------|--|
| 1. Allowable Operating Frequency: | A) Mechanical
(I) Momentary Max 120 operation/min
(II) Alternating Max 60 operation/min
B) Electrical - Max 20 operation/min. |
| 2. Current Rating | Resistive Load 5 A @ 250V AC OR 30V DC
Inductive Load 3 A @ 250V AC OR 30V DC |
| 3. Insulation resistance | Max 100 M ohms @ 500 V DC |
| 4. Dielectric strength | Between non-continuous terminals -
600 V AC for 1 min.
Between different poles 2000 V AC for 1 min.
Between each terminals and ground -
2000 V AC for 1 min. |
| 5. Mechanical life | Min 100,000 operations |
| 6. Electrical life | Min 100,000 operations at \circ
2A @ 250V AC / 28V DC @ +40 C |
| 7. Initial Contact resistance | Max 60 m ohms |
| 8. Terminal strength | Soldered terminal 12 N for 1 min |
| 9. Stroke | Approx 3 mm |

Environmental

- | | |
|-----------------|--|
| 1. Temperature | |
| a) Storage | : -25°C to + 65°C |
| b) Operating | -20°C to + 40°C |
| 2. Damp Heat | : 16 hrs @
RH 85% at 40°C |
| 3. Vibration | : 10 - 55 Hz, 3mm peak
(1 hr.on each axis) |
| 4. Impact Shock | : Peak acceleration
750 m/s ² for
5 m sec duration
In all 6 direction. |
| 5. Salt mist | : As per JSS 50101
For 48 hrs. |

MATERIAL & FINISH

METALS:- Stainless Steel, BerylliumCopper and Brass as required.

PLASTICS:- Thermoset and Termoplastic are UL-94 V0 grade.

PLATING:- Heavy Silver OR Gold on Nickel as required.

ORDERING DETAIL FOR PRE ASSEMBLED COMPLETE SWITCH.

COMPONENTS	PART No.
SWITCH MODULE	64 SW ___ ___
BODY	64 BD ___ ___ ___ ___
BARRIER	64 BR ___
LED	64 LD ___
COLOUR PLATE	64 CP ___ ___
BUTTON	64 BT ___ ___ ___ ___

A Special **customer specific number** will be allotted keeping the above Configuration.

Ordering Detail Example:

Switch Module	64 SW	2	M	means	2 Switch Momentary Type.
Body	64 BD	S	A 2 4	means	Body for full display 24V Switch
Barrier	64 BR	K		means	Black Short Barrier
LED	64 LD	R		means	Red Colour LED
Colour Plate	64 CP	1	R	means	Red Colour full display lens.
Button	64 BT	S	A 2 4	means	Button for full display 24 V Switch

All Dimensions in mm.